

Hexagon socket bolt M6x8

PCD31

Type

CLG-1-S1 - ** - ** - ** EC
 Common type Switch The space between H and L Size from under flange to center of float

1

CODE	Switch
00	None
0K	One for lower limit
K0	One for upper limit
KK	One each for upper and lower limits space between H and L
3K	Three
4K	Four

2

The space between H and L	"A" Size
~ 50 mm	132 mm
55 ~ 100 mm	182 mm
105 ~ 150 mm	232 mm
155 ~ 200 mm	282 mm
205 ~ 250 mm	332 mm
255 ~ 300 mm	382 mm
305 ~ 350 mm	432 mm
355 ~ 400 mm	482 mm
405 ~ 450 mm	532 mm
455 ~ 500 mm	582 mm

3

SIZE	Size from under flange to center of float
50	The custom-designed size of 50mm or more can be produced.

Specification of Proximity Sensors

Load voltage	DC 12~24 v
Control output	Load current 3~100 mA
	Diagnostic output 50 mA以下
Response frequency	0.5 KHz
Ambient temperature range	-25~70°C

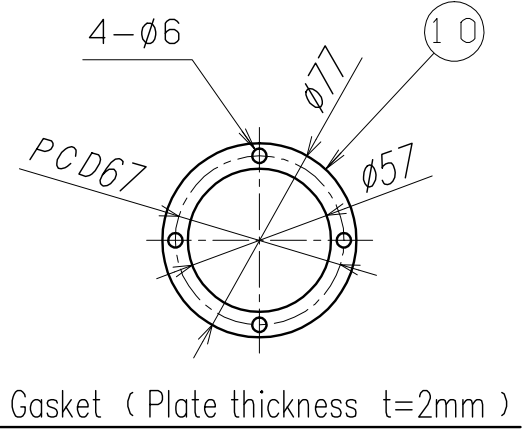

15	Bracket	**	Fe	BK-004	
14	Stopper	**	Aluminum	AL12-001	
13	Stopper	1	Aluminum	AL12-001	
12	Proximity Sensors	**	OMRON YAMAHA	E2E-X7D1-N / FL7M-7J6HD	
11	Hexagon socket bolt	4		M5	
10	Gasket	1	Silicone rubber	G67-001	
8	Float	1	Polypropylene	W50-001	
7	Shaft	1	SUS304	P3-002	
6	Flange	1	Aluminum	F80A-020	
5	Pipe	1	Polyarylate	S50-002	
4	Collar	1	Fe	KC-427	
3	Spacer	2	Acrylic	MS40-001	
2	Pipe & Free-size Bolt or Tie rod	4	SUS304 & SS400	Pipe (SUS304) & FREE-SIZE BOLT (SS400) or ø8 Tie rod (SUS304)	
1	Flange	1	Aluminum	F80A-010	
No.	PART NAME	Q'TY	MATERIAL	TYPE	REMARKS

Address 1519, Wakabadai
 Meito-ku, Nagoya-shi, Aichi 465-0015,
 Japan
 Tel: 052-760-3365 Fax: 052-760-3375

Note
 2014.02.10

APPROVED CHECKED DESIGNED SCALE NAME
 1/3
 CLEAN LEVEL TOWER (Type: Machining Oil)
 CLG-1-S1-**-**-**EC
 KOIKE E&S CO., LTD.